



LUMINARIA ARTIST FOUNDATION

Awards/Grants Application FAQs

Who is eligible for Luminaria Artist Foundation awards?

All residents of Bexar County (who are at least 18 years old AND have 6 consecutive months of residency as of the date of submitted application) are eligible for Luminaria Artist Foundation awards.

What is the city of residence distinction in the Foundation awards?

The City of San Antonio has awarded grant funds to the Foundation. Grants made by the Foundation with these monies can only be given to artists who have a permanent residence (minimum of 6 months) within San Antonio. Other private funds can be awarded to Bexar County residents. The Foundation is dedicated to supporting artists within our regional community.

Who is eligible to apply?

- Foundation awards are open to individual working artists who create original work.
- All artists must have a valid U.S. taxpayer identification number (SSN, EIN, ITIN).
- All applicants must be residents of Bexar County, Texas, for 6 consecutive months as of the date of application.
- If awarded, applicant must maintain permanent residency in Bexar County, Texas, during the grant period.
- Artists who are proposing projects must demonstrate one or more of the following characteristics:
 - a potential for artistic growth and experimentation;
 - a significant shift in their work;
 - challenging and innovative exploration with new materials, concepts, or creative practices and processes; and/or
 - demonstration of high artistic quality.
- All applicants must be 18 years old as of the date of application.
- Applicants must have exhibited, performed, presented, and/or published artistic work in a public context in the past three years.
- The Foundation will confirm applicant eligibility.

Who is NOT eligible to apply?

- Members of the Foundation's Board of Directors (current or having served within the previous 12 months).
- Members of a judging panel during the current grant cycle.
- Substantial contributors to the Foundation.
- Employees or Consultants of the Foundation.
- Substantial independent contractors of the Foundation.
- Family members of the above five named categories of Ineligible Persons.
- Previous Foundation award recipients may not reapply for 2 grant cycles and must have submitted their final grant reports to the Foundation to be eligible.
- Any person not residing within Bexar County, Texas, for a minimum of 6 consecutive months.

- Groups of individual artists.
- Full-time students or soon-to-be students.
- Artists whose work is primarily commercial, decorative, or craftwork in nature.
- Persons under 18 years of age.
- Artists who have not exhibited, performed, presented, and/or published artistic work in a public context in the past three years.
- Persons who do not have a valid U.S. taxpayer identification number (SSN, EIN, ITIN).

How do I apply?

Applications are accepted through anyartist.org only. No FAX, e-mail, courier, mail, or other delivery methods. E-mail grants@luminariasa.org if electronic submission is not possible.

What is the student restriction in the grant application?

You may not apply if you are a student:

- enrolled full-time in any course of study; or
- planning to enroll full-time in any course of study.

I have a project idea to be done in collaboration with other artists, can we submit this jointly?

No, grants are made to individual artists only. However, an individual artist may submit a project where they are the creative director and producer and even performer. This would be a grant made for Original Production under the Performance Category.

What is the deadline for applications and materials?

Online application and materials upload deadline is 11:59 PM, February 24, 2021.

May I submit more than one application?

No. Only one application per applicant is allowed each grant cycle.

May I submit a project that has been already performed/exhibited?

No. The Foundation awards are for projects that have yet to be realized, exhibited, and/or performed.

Who do I contact if I have any questions about my application?

If you have any questions, please email: grants@luminariasa.org. Please give specific details about your question and include your name and telephone number.

How do you select the artists to receive grants?

Artists are selected by a panel of regional and national arts experts.

If I am awarded a grant, when will I receive the money?

Half of the award (50%) will be given to the artist upon contract signing. The second portion (30%) will be awarded at midpoint of the project after submitting the interim report detailing progress thus far. To receive the final 20%, the artist must submit a final report to the Foundation.

If I am awarded a Foundation grant, must my project be completed and performed/exhibited by the conclusion of the grant period (March 14, 2022)?

Yes. Your project must be completed by the end of the grant period. If, however, you encounter obstacles, please contact grant administrators immediately at grants@luminariasasa.org.

Can you explain why you don't award grants for performance other than original production?

Foundation grants are made for original work only. As such, we don't make grants for performances but rather for original composition, original choreography, and original production.

Is the grant taxable?

Yes. Award funds are taxable to the recipients under IRS guidelines. Recipients should consult their tax advisor regarding proper reporting for the award. Each artist receiving an award will receive a Form W-9 each tax year for completion and return before receiving the award funds.

What is not funded?

The Foundation does not make grants to pay for:

- academic research or to fund study toward an academic professional degree;
- past debts or legal fees;
- the purchase of real estate;
- moves to other cities;
- the costs of installations, commissions, or projects fully funded by others; or
- artist's travel, unless such travel is integral to the application project.

I need help making a PDF to upload for my application, can you help me?

Yes. To convert your Word document to PDF, open the document in Word. Select "Print" from the "File" Menu. In the bottom left-hand corner, there is a button called "PDF", click this button and select the first option "Save as PDF". See illustrations below.

STEP 1:

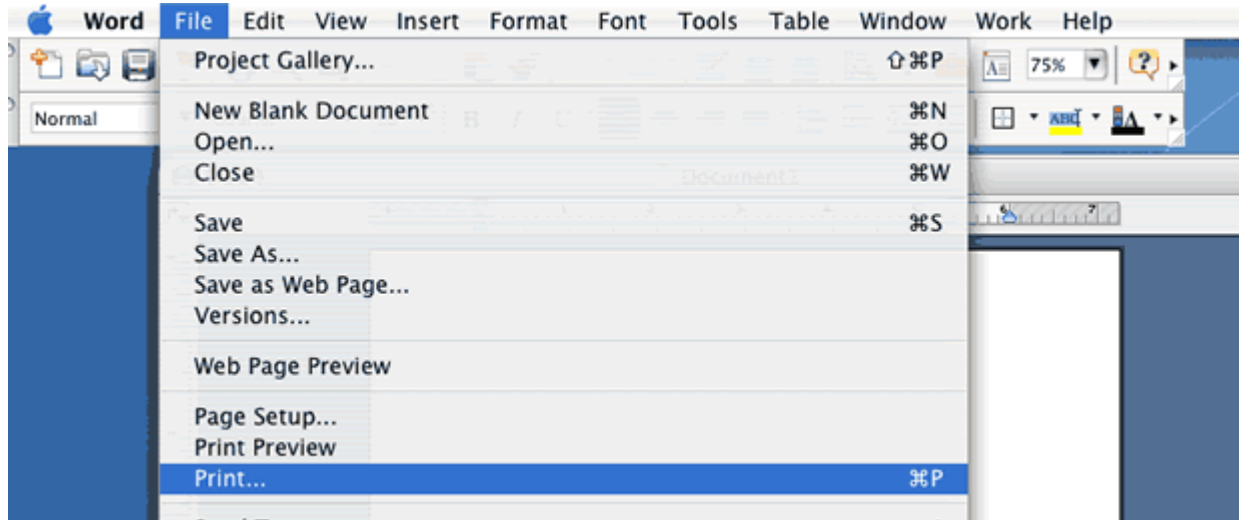

STEP 2:

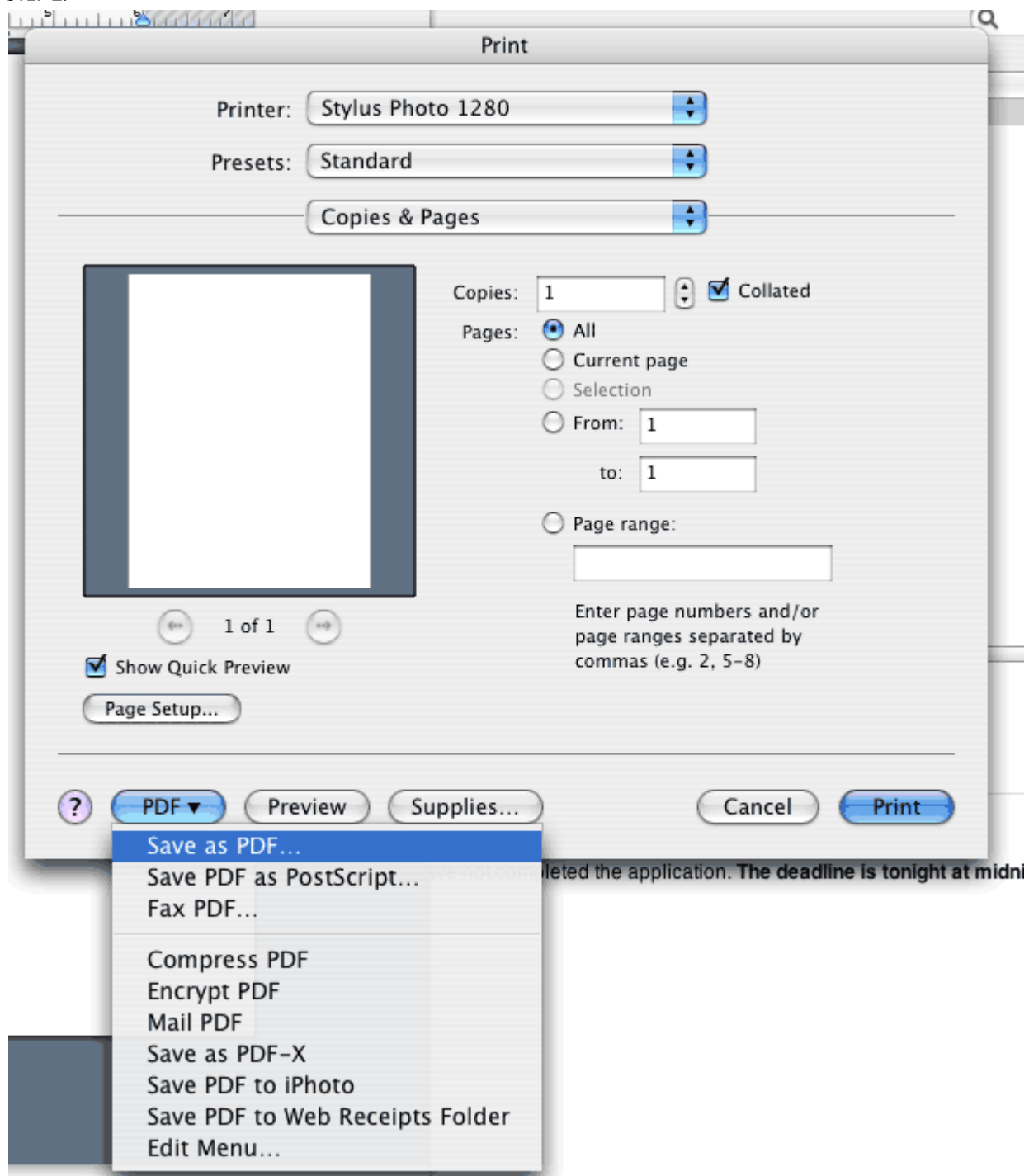

Or you can use one of the following free websites to convert your Word and text documents to PDF:

- [PDFOnline](#)
- [PrimoOnline](#)
- [PDF Converter](#)
- [iLovePDF](#)